

### Standard equipment

- Manual emergency lowering device
- Battery charger with automatic switch-off
- Low battery alert
- Battery switch-off
- Inclinator with cut out and alarm
- Load sensor with audible/visual motion cut out and alarm
- Electrical scissor protection
- Non marking tires
- Cylinder holding valve
- Non-slip deck surface
- Full height access gate with spring-lock

### Benefits

- ✓ Smooth roller castors with non-marking tyres suitable for soft ground
- ✓ It can be driven through standard doorways and carried in passenger elevators
- ✓ Ease of transport thanks to fork lift, lifting points and several slinging hook points
- ✓ Outstanding battery capacity provides long endurance
- ✓ Safe and reliable emergency lowering device with pull-up handle
- ✓ Digital inclinometer with cut out and audible alarm when exceeding the allowable tilt angle (no stabilisers required)
- ✓ Battery charger can be switched on for long periods, ensuring 100% battery charge

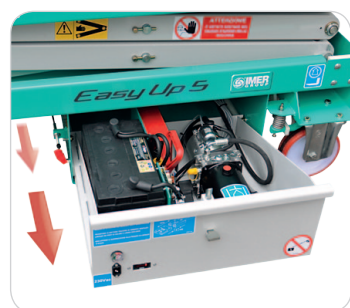
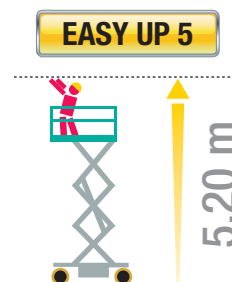

All the component parts are easily accessible for servicing.

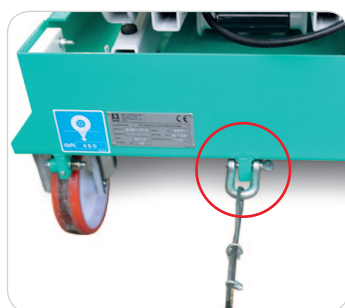

Winching eye for easy transport.

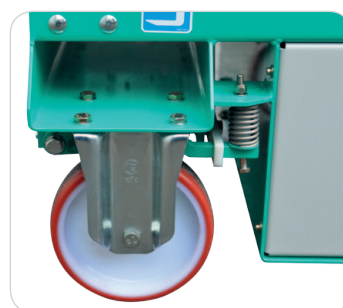

Auto braking on castors.



Removable control allows for easy and safe movement. Equipped with key switch and emergency stop button.

### EASY UP 5

Number of scissors		3
A	mm	3200
B	mm	5200
C	mm	60
D	mm	1790
E	mm	690
Capacity (including 1 person)	kg	200
Electric motor (power pack)	kW	1.6
Battery	V/Ah	12/105
Battery charger	V	230
Oil tank capacity	l	2
Lifting time	s	17/17
Max side/longitudinal tilt angle	degrees	1.3/2.5
Total weight	kg	390

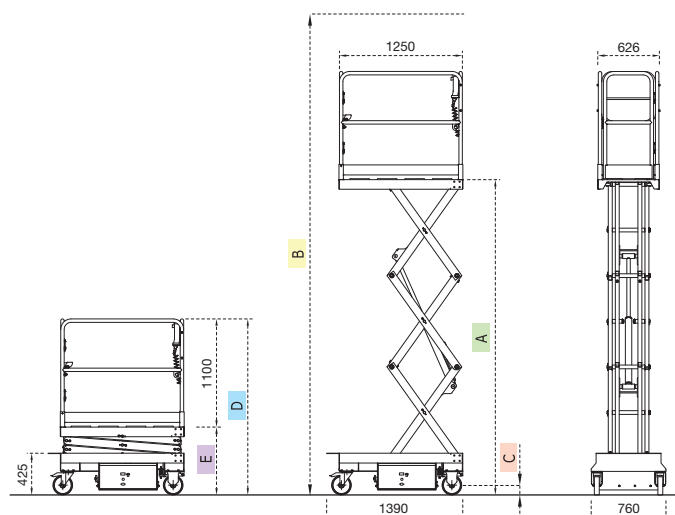

# Easy Up 5 Picking

## Standard equipment

- 2WD traction, DC electric motors and electromagnetic brakes
- Swivel caster interlock for straight line driving
- Selector for 3 different proportional speed
- Non marking tires
- Double material tray, non-slip, adjustable and fixed
- Double door access gate with spring-lock
- Control box on platform IP65, with proportional joystick and emergency stop
- Ground control panel with key switch
- Inclinomometer with audible/visual alarm and motion cut out
- Load sensor with audible/visual alarm and motion cut out
- Electrical scissor protection
- Pothole protection
- Audible motion alarm, horn and flashing beacon
- Low battery alert
- Battery charger with automatic switch-off
- Manual emergency lowering device
- Cylinder holding valve

## Benefits

- ✓ Higher productivity thanks to the powered traction also allowed at full height
- ✓ Excellent manoeuvrability, safe, quick and precise positioning in very congested sites
- ✓ Large material tray, non-slip, adjustable in 8 positions
- ✓ It can be driven through standard doorways and carried in passenger elevators
- ✓ Ease of loading either by ramps, forklift pockets and crane lifting points
- ✓ Light and handy, with non marking tires, ideal for delicate and/or raised access flooring
- ✓ Outstanding battery capacity provides long endurance
- ✓ Battery charger with automatic compensation charge for long periods of inactivity. Just leave it ON.
- ✓ Emergency lowering device easy and quick to operate

### EASY UP 5 Picking

Number of scissors		3
A	mm	3200
B	mm	5200
C	mm	25
D	mm	1820
E	mm	710
Platform dimensions	mm	700x620
Material tray dimensions	mm	500x620
Platform capacity (including 1 person)	kg	120
Material tray capacity	kg	80
Total capacity (including 1 person)	kg	200
Electric motor (power pack)	kW	2
Electric drive motors	V/kW	24/1
Battery	V/Ah	2 x 12/105
Battery charger	V	230
Oil tank capacity	l	2
Lifting time	s	17/20
Max side/longitudinal tilt angle	degrees	1.5/2.5
Gradeability	%	25
Traction speed	km/h	0 - 4
Safety traction speed	km/h	0.6
Internal turning radius	m	0
External turning radius	m	1.25
Total weight	kg	585



Large material tray, non-slip, adjustable in 8 positions.



Proper and ergonomic components disposition for easier and faster maintenance task.



Sturdy IP65, simple and intuitive control box.



Swivel castor interlock for straight line driving.



Ground control panel, intuitive and well protected from accidental bumps.



### EASY UP 5 Picking

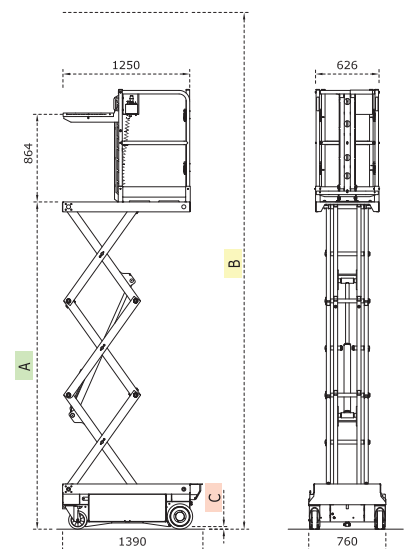
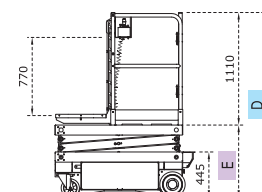
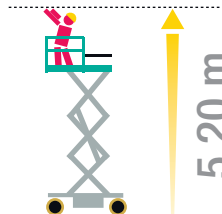

## Standard equipment

- Manual emergency lowering device
- Battery charger with automatic switch-off
- Low battery alert
- Battery switch-off
- Inclinometer with cut out and alarm
- Load sensor with audible/visual motion cut out and alarm
- Electrical scissor protection
- Non marking tires
- Cylinder holding valve
- Non-slip deck surface
- Full height access gate with spring-lock
- 2WD traction, DC electric motors
- Electromagnetic brakes on the 2WD
- Swivel caster interlock for straight line driving
- Pothole protection
- Control box on platform IP65, with proportional joystick and emergency stop
- Selector for 3 different proportional speed
- Audible motion alarm
- Horn
- Ground control panel with key switch
- Flashing beacon

## Benefits

- ✓ Smooth roller castors with non-marking tyres suitable for soft ground
- ✓ It can be driven through standard doorways and carried in passenger elevators
- ✓ Ease of transport thanks to fork lift, lifting points and several slinging hook points
- ✓ Outstanding battery capacity provides long endurance
- ✓ Safe and reliable emergency lowering device with pull-up handle
- ✓ Digital inclinometer with cut out and audible alarm when exceeding the allowable tilt angle (no stabilisers required)
- ✓ Battery charger can be switched on for long periods, ensuring 100% battery charge
- ✓ Higher productivity thanks to the powered traction also allowed at full height
- ✓ Reduced environmental impact by electric traction
- ✓ Easier loading operation on ramps
- ✓ Excellent manoeuvrability, safe, quick and precise positioning in very congested sites



### EASY UP 5 SP

Number of scissors		3
A	mm	3200
B	mm	5200
C	mm	25
D	mm	1810
E	mm	710
Capacity (including 1 person)	kg	200
Electric motor (power pack)	kW	2
Electric drive motors	V/kW	24/1
Battery	V/Ah	2 x 12/105
Battery charger	V	230
Oil tank capacity	l	2
Lifting time	s	17/20
Max side/longitudinal tilt angle	degrees	1.5/2.5
Gradeability	%	25
Traction speed	km/h	0 - 4
Safety traction speed	km/h	0.6
Internal turning radius	m	0
External turning radius	m	1.25
Total weight	kg	500

### EASY UP 5 SP

